

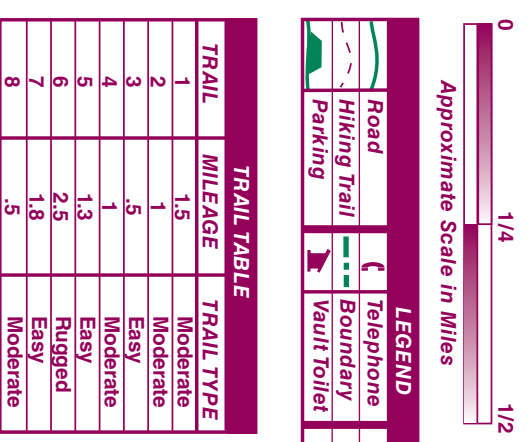

# CHAIN O' LAKES STATE PARK

2355 E. 75 South • Albion, Indiana 46701 • (260) 636-2654  
2,718 Acres Established 1960

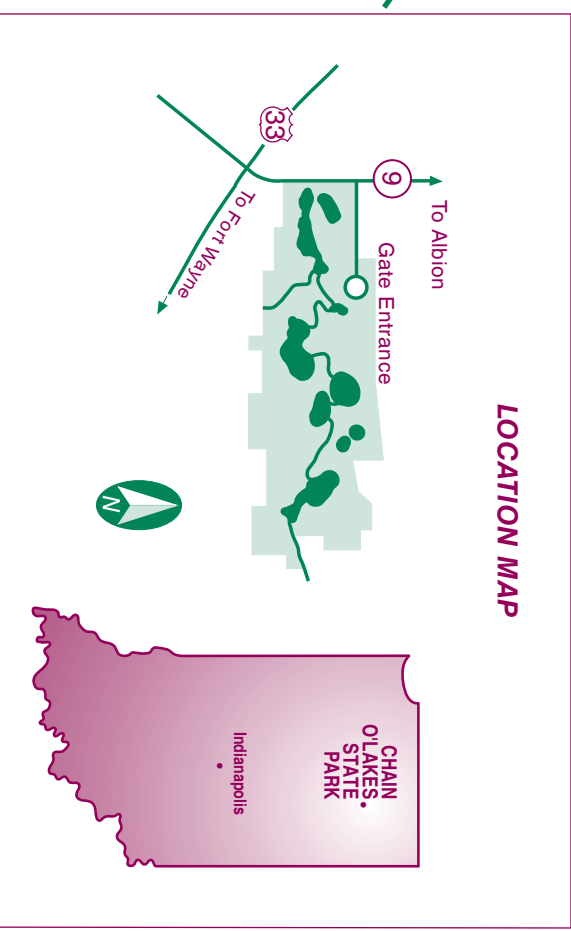
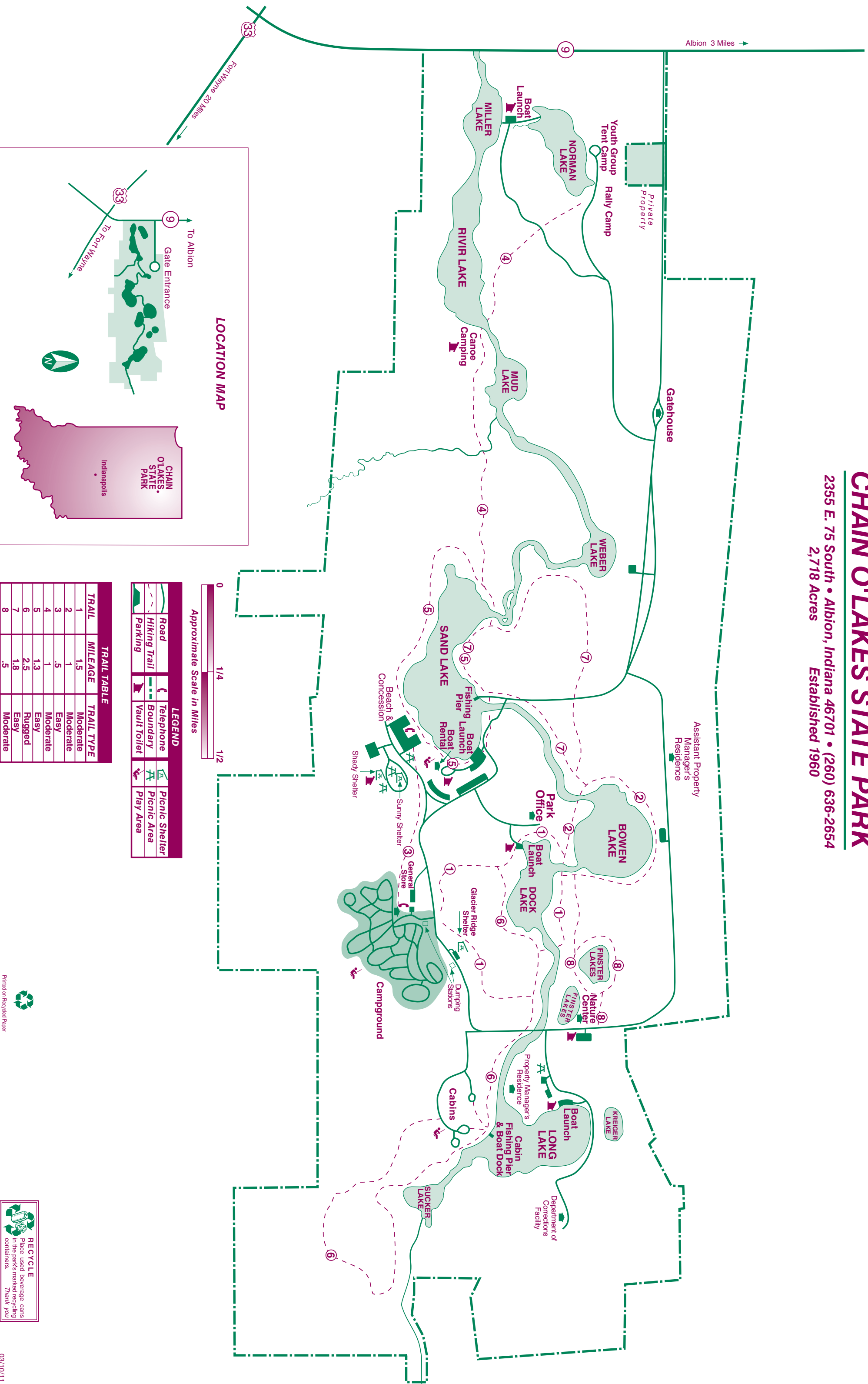

TRAIL	MILEAGE	TRAIL TYPE
1	1.5	Moderate
2	1	Moderate
3	.5	Easy
4	1	Moderate
5	1.3	Easy
6	2.5	Rugged
7	1.8	Easy
8	.5	Moderate

