



# Indiana Department of Environmental Management Office of Water Quality Wetlands Section

**Publication Date:**  
March 26, 2024

**Closing Date:**  
April 16, 2024

**IDEM ID Number:**  
2024-58-2-EJW-A

**Corps of Engineers ID Number:**  
LRE-2022-00769-102

## PUBLIC NOTICE

### To all interested parties:

This letter shall serve as a formal notice of the receipt of an application for **Section 401 Water Quality Certification** by the Indiana Department of Environmental Management (IDEM). The purpose of the notice is to inform the public of active applications submitted for water quality certification under Section 401 of the Clean Water Act (33 U.S.C. § 1341) and to solicit comments and information on any impacts to water quality related to the proposed project. IDEM will evaluate whether the project complies with Indiana's water quality standards as set forth at 327 IAC 2.

- 1. Applicant:** Brian Brown  
GRE Development, LLC  
10808 LaCabreah Lane  
Fort Wayne, IN 46845
- 2. Agent:** Ashlee Nichter  
Earth Source, Inc.  
14921 Hand Road  
Fort Wayne, IN 46818
- 3. Project location:** 4500 Woods Road, Fort Wayne, IN 46818  
Latitude: 41.214911      Longitude: -85.204296
- 4. Affected waterbody:** Sections V, VIII, IX, and X forested and emergent federally jurisdictional wetlands will be impacted. Sections XII and XIII will also be impacted but are isolated and exempt from permitting.
- 5. Project Description:** A 158-lot residential development is being constructed on 428 acres located approximately 1.75 miles Southwest of Hometown, Allen County. 0.94 acres of federally jurisdictional emergent and forested wetlands will be impacted with clean dirt fill for the construction of residential lots, roads, and associated utilities. 0.02 acres of Section X forested wetland will be impacted by a 25-foot long, 24" wide HDPE culvert and clean dirt fill for the construction of a temporary access road that will later be utilized for a permanent crossing. 3.12 acres of forested wetland credit and 0.32 acres of emergent wetland credit will be purchased from the Openings Mitigation Bank to fulfill compensatory mitigation requirements.  
Additional information may be found online at <https://www.in.gov/idem/5474.htm>

**Comment period:** Any person or entity who wishes to submit comments or information relevant to the aforementioned project may do so by the closing date noted above. Only comments or information related to water quality or potential impacts of the project on water quality can be considered by IDEM in the water quality certification review process.

**Public Hearing:** Any person may submit a written request that a public hearing be held to consider issues related to water quality in connection with the project detailed in this notice. The request for a hearing should be submitted within the comment period to be considered timely. The request should also state the reason for the public hearing as specifically as possible to assist IDEM in determining whether a public hearing is warranted.

**Questions?** Additional information may be obtained from Evan White, Project Manager, by phone at 317-671-6698 or by e-mail at [evwhite@idem.in.gov](mailto:evwhite@idem.in.gov). Please address all correspondence to the project manager and reference the IDEM project identification number listed on this notice. Indicate if you wish to receive a copy of IDEM's final decision. Written comments and inquiries may be forwarded to -

Indiana Department of Environmental Management

100 North Senate Avenue  
MC65-42 WQS IGCN 1255  
Indianapolis, Indiana 46204-2251 FAX: 317/232-8406

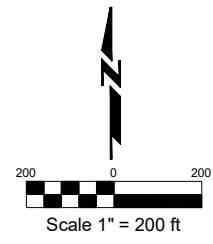
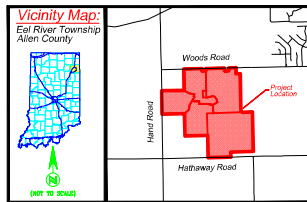

**Not to scale. Reduced to fit 11x17**

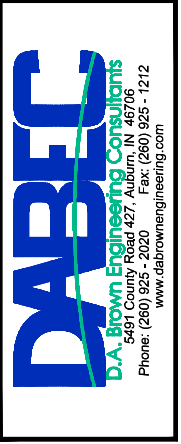
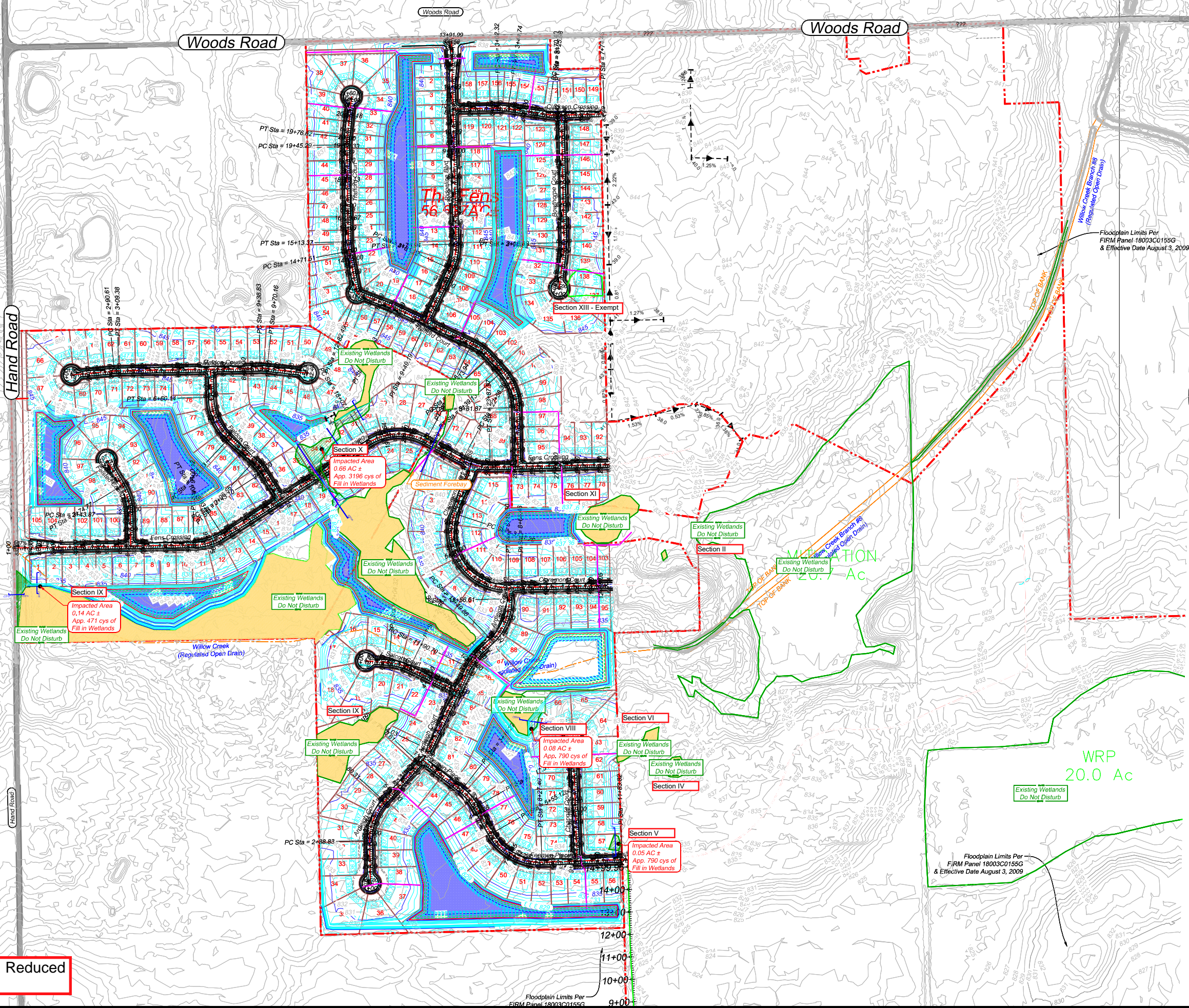

The Fens Master Plan Set  
Summit, Lakes, Crossing  
Sanctuary, & Sanctuary Extend  
Allen County  
Indiana

| Revisions |             |
|-----------|-------------|
| Date      | Description |
|           |             |
|           |             |
|           |             |
|           |             |

|         |            |             |   |
|---------|------------|-------------|---|
| Date:   | 10/20/2023 | Drawn By:   |   |
| Scale:  | As Noted   | Checked By: |   |
| Job No. | 2112-01    | Sheet No.   | 1 |

K:\2023\12-01\Fens Master Plan\DWG\Wetlands\2112-01\_Fens\_Wetlands\_011824.dwg, Saved by: mchewels, 1/22/2024 11:34:52 AM, 1:2.5624